

Colenta[®] INDX 900 NDT

Automatic NDT Industrial X-Ray Film Processor

For all standard NDT X-Ray Films.
Especially designed for the use in mobile darkroom installation (containers, trucks,....)

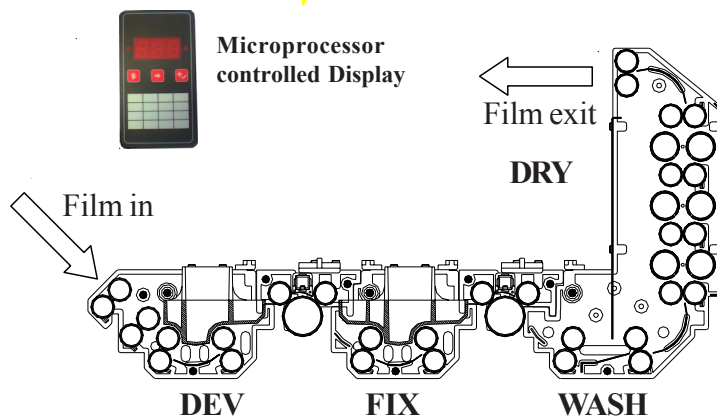

with LVTT (Low Volume Thin Tank) rack design, chemistry fully protected against air oxydation.

with **Intermediate Wash** between developer and fixer rack for reduced maintenance (cleaning requirements by the user), for reduced carryover of developer/contamination of fixer and reduced fixer replenishment.

with **Programmable Microprocessor Controller** incl. **Sensorbar** (4 pulsed IR-sensors) for exact **Detection of Film Area** for precise replenishment of chemistry, to control **Anti-oxidation/Standby-Replenishment Cycles, Anti-Crystallisation Cycles, Standby Mode, Processing Time/Speed** and **Dryer/Developer Temperature** of the processor.

with **Inline Heatexchanger** for developer/fixer heating with overheat protection and cold water cooling facility ($\pm 0,2^{\circ}\text{C}$ for dev.).

with **Warm Air Dryer** with overheat protection.

with maintenance free, **Inline Gear Drive System** (no worm gear drive used!).

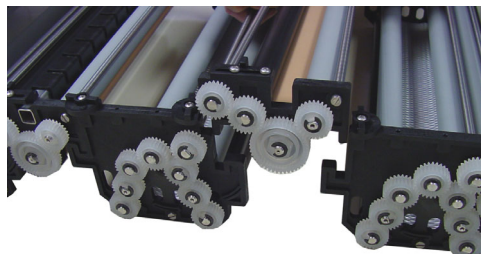

Skip over segments for easy access for cleaning.

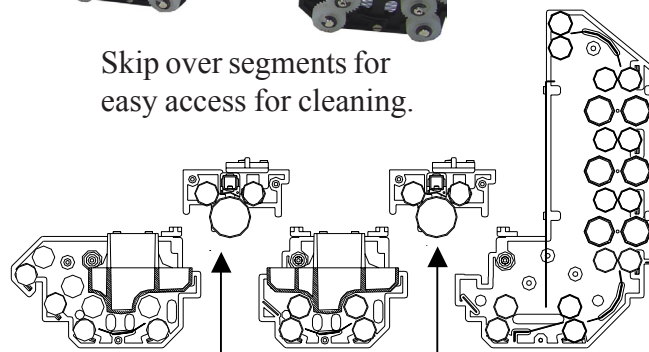

Intermediate Rinse Cross over rollers

Technical Specifications:

max. Film width: 36cm/14inch
min. Film lenght: 10cm/4inch
Tankbody PA: Dev/Fixer/Wash 2,3 lt. each
Dev. Temp. Range: 18-43°C $\pm 0,2^{\circ}\text{C}$
Dryer Temperature: approx 50°C
Replenishment: variable / programmable 0-800ml/m²

Capacity at cycle time (Dry to Dry):	intake speed (cm/min)	dev time (sec)
2,7min	38	30
4,5 min	23	50
9,5 min	11,5	99
13,6min	8	150

Electr. Power Supply: 230V, 50/60 Hz, 1,7kW
Water Supply: R3/4", max 18°C, 3-6 bar
1,5 - 2 lt./min

Water Drain: 32mm (5/4inch) hose or tube



Technical specification subject to change without notice.

see additional:
Technical
Data sheet

COLENTA LABORTECHNIK
Ges.m.b.H. & Co. KG
Neunkirchner Strasse 117
A-2700 Wiener Neustadt
Tel.: +43-2622-28311-0
Fax: +43-2622-28311-7
E-mail: office@colenta.at

ACI-COLENTA
INTERNATIONAL Div.
Forge Close, Little End Rd,
Eaton Socon, Cams. UK
Tel. +44-1480-211118
Fax:+44-1480-215236
E-mail: aci@patflaherty.com